

PROSAN+ DETERGENT CHLORINE TABLETS

SANITISING CHLORINE SOLUTION – GENERAL DISINFECTION

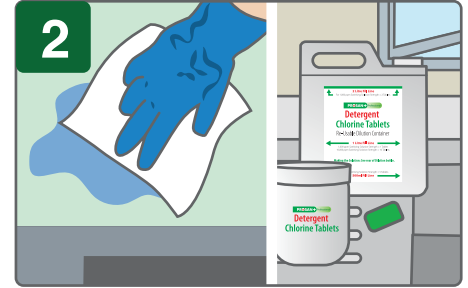

Wear appropriate PPE: Gloves & Apron. When using solution, wear safety glasses with side shields in case of splashing. If in a confined space, open a window/door to ensure adequate ventilation.



Prepare the Prosan Plus solution as per the chart below using cold potable (tap) water. Remove gross contamination with paper towel prior to applying Prosan Plus solution. **Dispose of all the Spill material as Clinical Waste.**



Clean the spill area with Neutral Detergent (Detergent Wipes). Use solution according to hospital policies. When disinfecting items such as commodes and mattresses, allow to dry fully before rinsing.



Keep prepared solution for no longer than 24 hours. Dispose of residual solution into an appropriate drain, sluice or sink with running water.



Remove gloves and apron and dispose of as Clinical Waste then wash hands thoroughly.

DILUTION INSTRUCTIONS

FOR SANITISING CHLORINE SOLUTION – 1,000 PPM AVAILABLE CHLORINE			CONTACT TIME
Sanitising solution for: Disinfection of the Environment Sporicidal - C.difficile	1 Tablet per 1L	Disinfection of the Environment Sporicidal - C.difficile	5 minutes 10 minutes

HEALTH & SAFETY

DO NOT use directly on Vomit or Urine Spills

DO NOT breathe in fumes, gas, vapours, powder or mist

AVOID contact with Eyes and Skin

AVOID prolonged contact with metals.
TAKE CARE: Solution will bleach fabrics

ALWAYS dispose of used materials as Clinical Waste

ALWAYS make a fresh solution every 24 hours

ALWAYS work in a well-ventilated area

ALWAYS replace tablet pot lid and store in a secure, dry place

USE THIS BIOCIDES SAFELY: REFER TO LOCAL HOSPITAL POLICY. REFER TO THE PRODUCT SAFETY DATA SHEET. READ THE PRODUCT LABEL.